



City of Bay Minette

Variance Application

301 D'Olive Street · Bay Minette, Alabama 36507
Phone (251) 580-1650 · COBM_Planning@cityofbayminetteal.gov

Office Use Only

V - _____
Fee: \$300 + \$10 per Certified Letter
Paid: ☐ Credit Card ☐ Cash
☐ Check. # _____
Date Paid: _____

Are you the property owner? ☒ Yes ☐ No

(If you are not the property owner you must submit an Agent Authorization Form signed by the property owner)

Name: Charles S Stevens Chuck Stevens Ford Date: 7-7-2023

Mailing Address: 400 Hwy 31 South

City: Bay Minette State: AL Zip Code: 36507

Phone Number: 251-937-1000 Email: Chuck@csaemail.com

Site Information

Property Address: 1304 Hwy 31 S Bay Minette AL 36507
or Property Location: _____

*Parcel No.: 23-05-21-2-009 - 025600 *PPIN No.: 013958

*Parcel or PPIN information must be completed

Current Zoning: _____

The purpose of this Variance is to allow:

relocation of sign 138' north of current location

What are the conditions which prevent you from using this property in accordance with the zoning ordinance?

*Variance ordinance excerpt is included in packet

Current sign exceeds sign limit both in height and square footage. Variance needed and granted for install of current sign in the past

I, the undersigned applicant, understand that payment of these fees does not entitle me to approval of this variance and that no refund of these fees will be made. I have reviewed a copy of the applicable zoning regulations and understand that I must be present on the date of the meeting. I understand and authorize City Staff to conduct site visits, as needed in relation to this request.

Chuck Stevens

7/7/23

Signature of Applicant (Owner of Property or Authorized Agent)

Date

Submittal Requirements

- ☒ Application Received 7/7/23
- ☐ Fee
- ☐ Agent Authorization Form (if applicant is not the owner)
- ☐ Complete Legal Description of Property
- ☐ Plot Plan or Survey – indicating any existing structures, proposed structures, and setbacks from property lines.

Site Location
Road Centerlines
BC Revenue Parcels

Site Plan
V-23001 Chuck Stevens
Sign Variance Request



SUS HWY 31

Proposed Sign Location

138'

Existing Sign Location

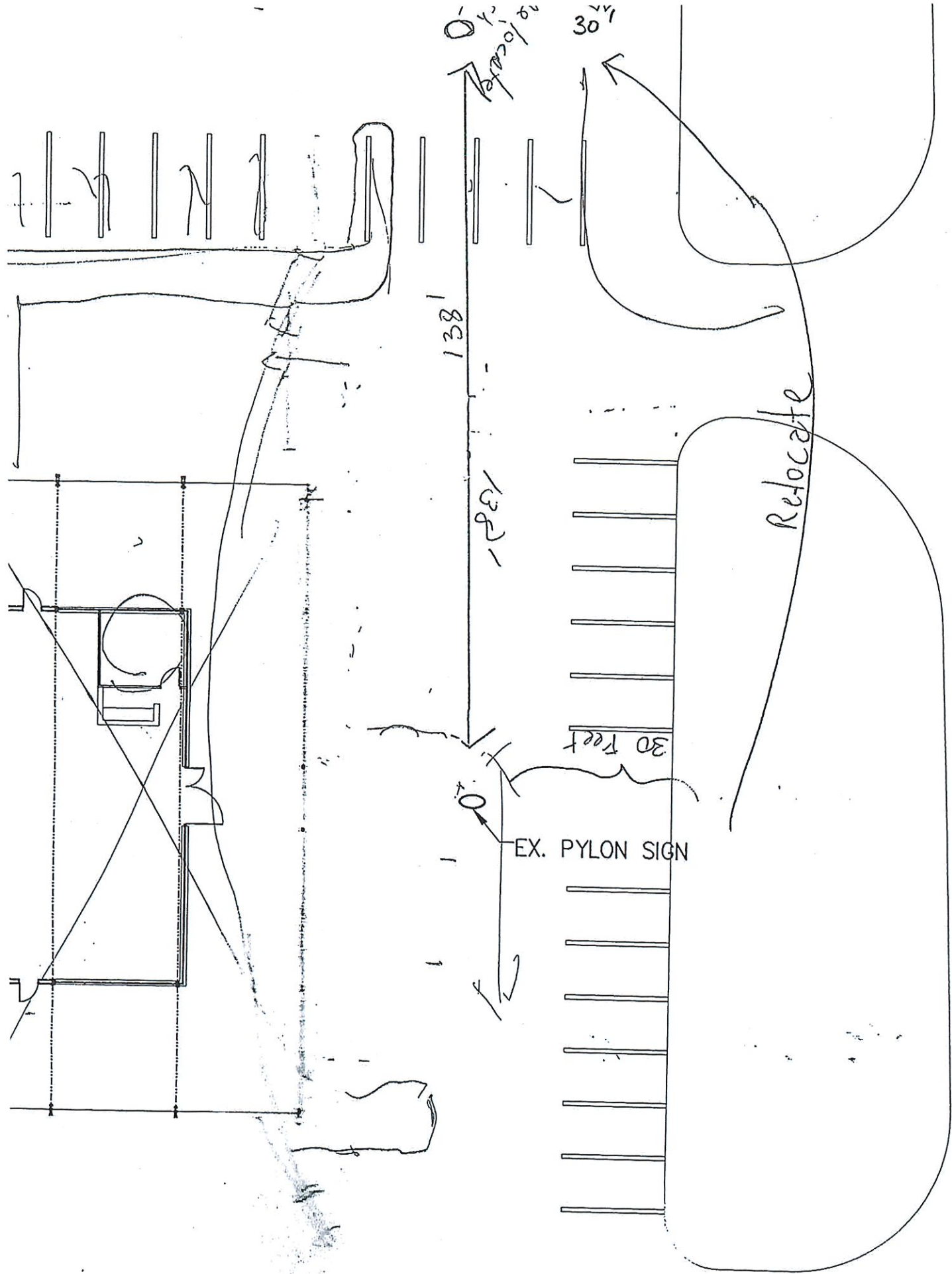

U S HIGHWAY 31



07.20.2022

E24560 7/22/2022

FO F-100 P30

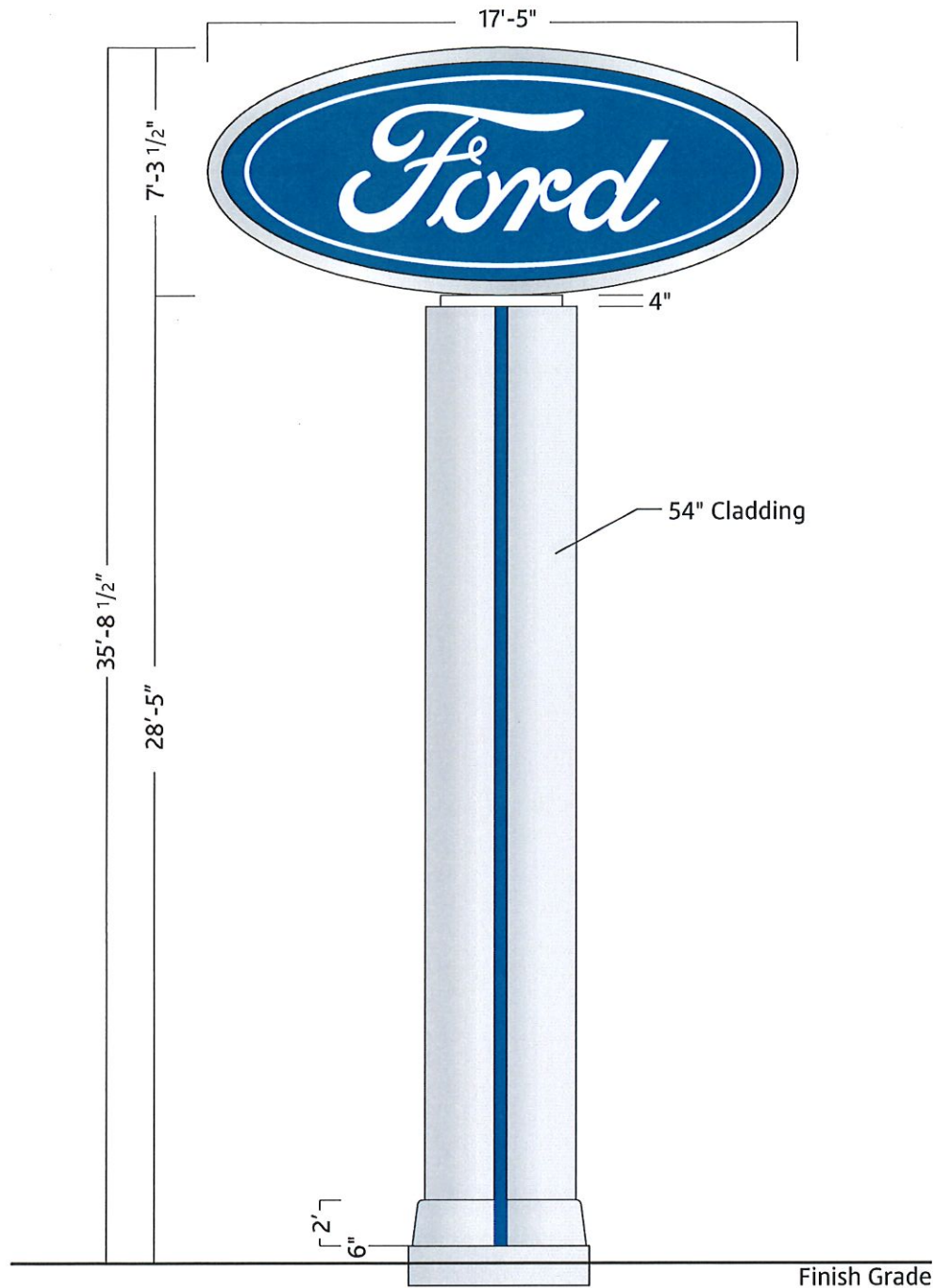

THIS DRAWING IS AN ARTISTIC REPRESENTATION TO BE USED FOR PERMIT AND ESTIMATING PURPOSES ONLY.
TRUE DIMENSIONS MUST BE PROVIDED BY ENGINEERING PRIOR TO PRODUCTION.



LINCOLN

This document is the sole property of AGI, and all design, manufacturing, reproduction, use and sale rights regarding the same are expressly forbidden. It is submitted under a confidential relationship, for a special purpose, and the recipient, by accepting this document assumes custody and agrees that this document will not be copied or reproduced in whole or in part, nor its contents revealed in any manner or to any person except for the purpose for which it was tendered, nor any special features peculiar to this design be incorporated in other projects.

Title: F100_P30

Customer: Ford

Date: 1/19/22

Drawn by: M. Folden

Customer Rep: N/A

Scale: $3/16"=1'$

